

HWF10DB2, HWF10DW2

10kg 500 Series Front Loader Washing Machine Ultra Fresh Air

Haier



HWF10DB2



HWF10DW2

Height

850 - 860mm

Width

595mm

Depth

593mm

Weight (Packaged)

79kg

Weight (Product)

75kg

FEATURES

- 10kg capacity fits a full basket or clothes or towels
- 5-star energy and 4.5-star water ratings
- 14 cycles, including a Woolmark Black certified cycle for machine-washable woollens
- Smart Dosing measures and dispenses detergent, while Essence Wash pre-mixes it to improve wash performance
- Ultra Quick effectively washes a 5kg load in under 30 minutes
- Ultra Fresh Air circulates air and clothes for up to 12 hours after a cycle - to help keep that 'just washed' feel
- UV Protect to kill more than 99.99% of bacteria*
- Inverter Direct-Drive motor delivers reliable performance, backed by a 10-year warranty on the motor (2 years parts and labour, additional 8 years parts only) for extra peace of mind
- Available in White or Dark, designed to pair with our matching Haier Heat Pump Dryer
- Wi-Fi connectivity with the SmartHQ™ app

*Independently tested to eliminate greater than 99.99% of staphylococcus aureus and E. coli using the Cotton cycle + UV Sanitise wash option

ACCESSORIES

- ASKDNB1 (Stacking Kit Dark)
- ASKDNW1 (Stacking Kit White)

The models shown in this Specification Guide (SG) may not be available in all markets and are subject to change at any time. Product specifications may vary from those shown. This SG should not be used as installation guidance for any product. Further information is required to safely and correctly install the products featured here. Specific installation guidance will be available with the product on delivery and on our website haier.com

HWF12DB1, HWF12DW1

12kg 500 Series Front Loader Washing Machine Ultra Fresh Air

Haier



HWF12DB1



HWF12DW1

Height
850 - 860mm

Width
595mm

Depth
661mm

Weight (Packaged)
87kg

Weight (Product)
84kg

FEATURES

- Large 12kg capacity for big wash days, bulky bedding, and more
- 5-star energy and 5-star water ratings
- 14 cycles, including a Woolmark Black certified cycle for machine-washable woollens
- Smart Dosing measures and dispenses detergent, while Essence Wash pre-mixes it to improve wash performance
- Ultra Quick effectively washes a 5kg load in under 30 minutes
- Ultra Fresh Air circulates air and clothes for up to 12 hours after a cycle - to help keep that 'just washed' feel
- UV Protect to kill more than 99.99% of bacteria*
- Inverter Direct-Drive motor delivers reliable performance, backed by a 10-year warranty on the motor (2 years parts and labour, additional 8 years parts only) for extra peace of mind
- Available in White or Dark, designed to pair with our matching Haier Heat Pump Dryer
- Wi-Fi connectivity with the SmartHQ™ app

*Independently tested to eliminate greater than 99.99% of staphylococcus aureus and E. coli using the Cotton cycle + UV Sanitise wash option

ACCESSORIES

- ASKDNB1 (Stacking Kit Dark)
- ASKDNW1 (Stacking Kit White)

The models shown in this Specification Guide (SG) may not be available in all markets and are subject to change at any time. Product specifications may vary from those shown. This SG should not be used as installation guidance for any product. Further information is required to safely and correctly install the products featured here. Specific installation guidance will be available with the product on delivery and on our website haier.com

HDHP10DB1, HDHP10DW1

10kg 500 Series Heat Pump Dryer Ultra Sense

Haier



HDHP10DB1



HDHP10DW1

Height

845 - 855mm

Width

595mm

Depth

680mm

Weight (Packaged)

64kg

Weight (Product)

59kg

FEATURES

- Large 10kg capacity to tackle everything from bulky bedding to everyday essentials
- 10-star energy rating for energy conscious households
- With 14 cycles for everything from Bedding to Bulky items
- Ultra Sense helps prevent over or under drying bulky items
- Refresh with Steam helps reduce wrinkles and smells in clothes
- Woolmark Blue certified Wool cycle for hand-wash only garments
- Triple Variable Speed technology controls the speed of the drum, fan and compressor to optimise drying in every cycle
- Reversible door for flexible installation
- Available in White or Dark, designed to pair with our matching Haier Front Load Washer
- Wi-Fi connectivity with the SmartHQ™ app

ACCESSORIES

- ASKDNB1 (Stacking Kit Dark)
- ASKDNW1 (Stacking Kit White)

The models shown in this Specification Guide (SG) may not be available in all markets and are subject to change at any time. Product specifications may vary from those shown. This SG should not be used as installation guidance for any product. Further information is required to safely and correctly install the products featured here. Specific installation guidance will be available with the product on delivery and on our website haier.com

Product Overview

PRODUCT DIMENSIONS

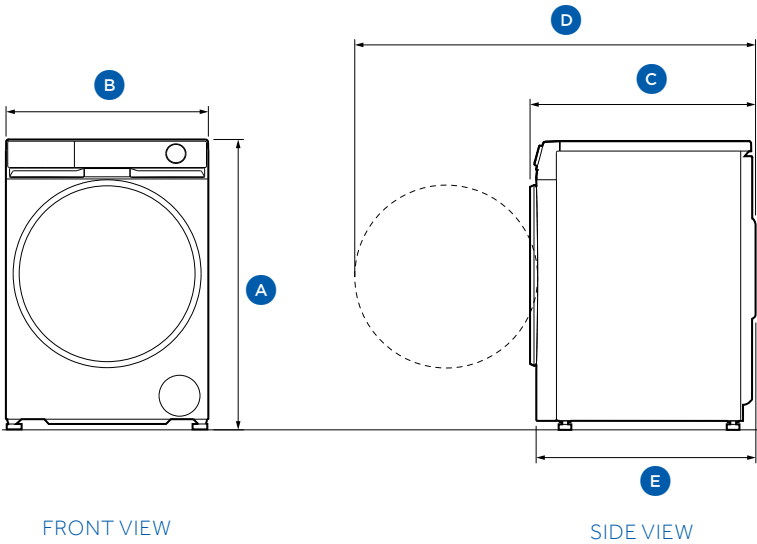

	mm
A Overall height	850 - 860
B Overall width	595
C Overall depth (door closed)	593
D Overall depth (door open)	1084
E Overall depth (excluding door)	570

CAVITY DIMENSIONS

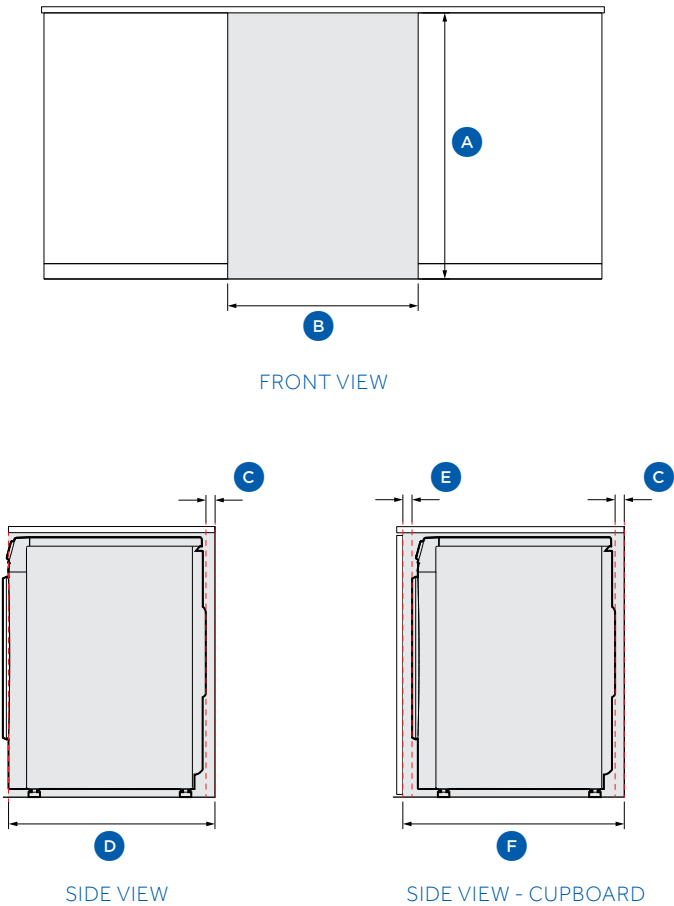

	mm
A Minimum height of cavity	865
B Minimum width of cavity	622
C Minimum clearance at back of cavity	30
D Minimum depth of cavity (excluding product door)	600
E Minimum clearance at front of cavity for in cupboard	30
F Minimum depth of cavity in cupboard	653

Note: If installing behind a cabinetry door, it must be hinged on the same side as the washing machine. There must be a minimum clearance of 30mm from the front of the washing machine door to the internal face of the cabinetry door for the product to operate safely.

The enclosed space must be provided with sufficient ventilation to meet local building code requirements or the door must be open while the product is operating.

SERVICES

- | | |
|--------------|---------------------|
| • Supply | 220-240 V, 50 Hz |
| • Service | 10 A |
| • Connection | Flex cord with plug |

The models shown in this Specification Guide (SG) may not be available in all markets and are subject to change at any time. Product specifications may vary from those shown. This SG should not be used as installation guidance for any product. Further information is required to safely and correctly install the products featured here. Specific installation guidance will be available with the product on delivery and on our website haier.com

Product Overview

PRODUCT DIMENSIONS

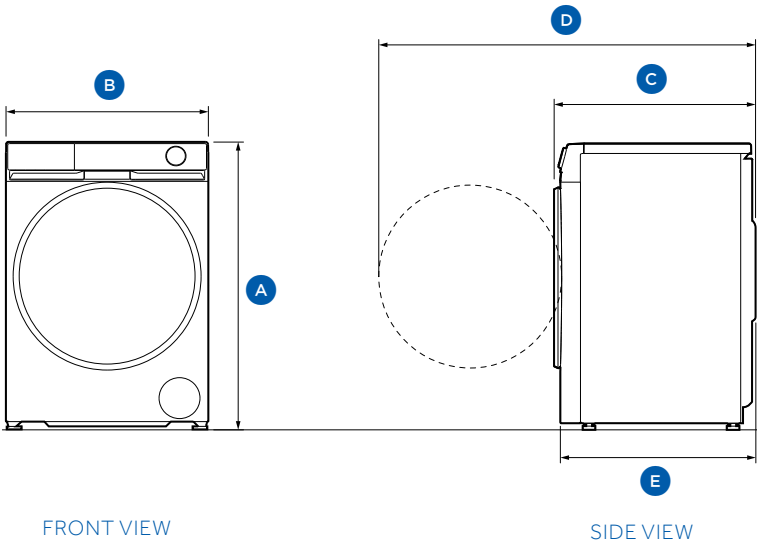

		mm
A	Overall height	850 - 860
B	Overall width	595
C	Overall depth (door closed)	661
D	Overall depth (door open)	1152
E	Overall depth (excluding door)	639

CAVITY DIMENSIONS

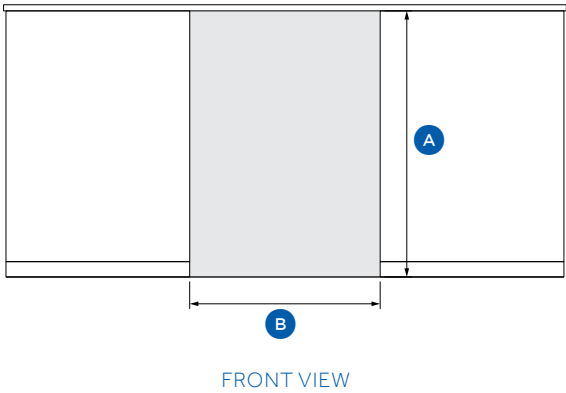

		mm
A	Minimum height of cavity	865
B	Minimum width of cavity	622
C	Minimum clearance at back of cavity	30
D	Minimum depth of cavity (excluding product door)	669
E	Minimum clearance at front of cavity for in cupboard	30
F	Minimum depth of cavity in cupboard	721

Note: If installing behind a cabinetry door, it must be hinged on the same side as the washing machine. There must be a minimum clearance of 30mm from the front of the washing machine door to the internal face of the cabinetry door for the product to operate safely.

The enclosed space must be provided with sufficient ventilation to meet local building code requirements or the door must be open while the product is operating.

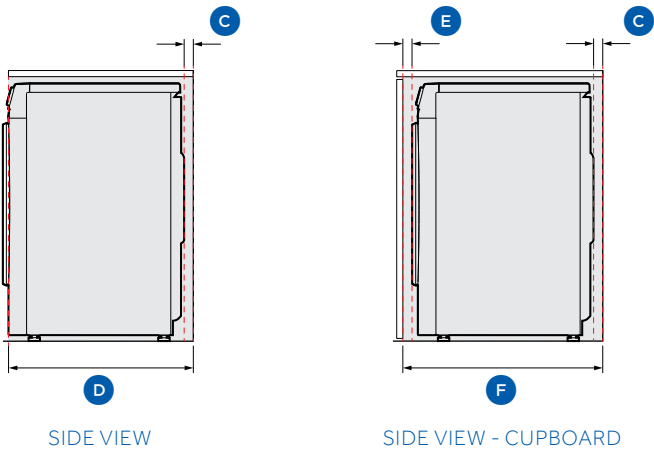

SERVICES

- | | |
|--------------|---------------------|
| • Supply | 220-240 V, 50 Hz |
| • Service | 10 A |
| • Connection | Flex cord with plug |

The models shown in this Specification Guide (SG) may not be available in all markets and are subject to change at any time. Product specifications may vary from those shown. This SG should not be used as installation guidance for any product. Further information is required to safely and correctly install the products featured here. Specific installation guidance will be available with the product on delivery and on our website haier.com

Product Overview

PRODUCT DIMENSIONS

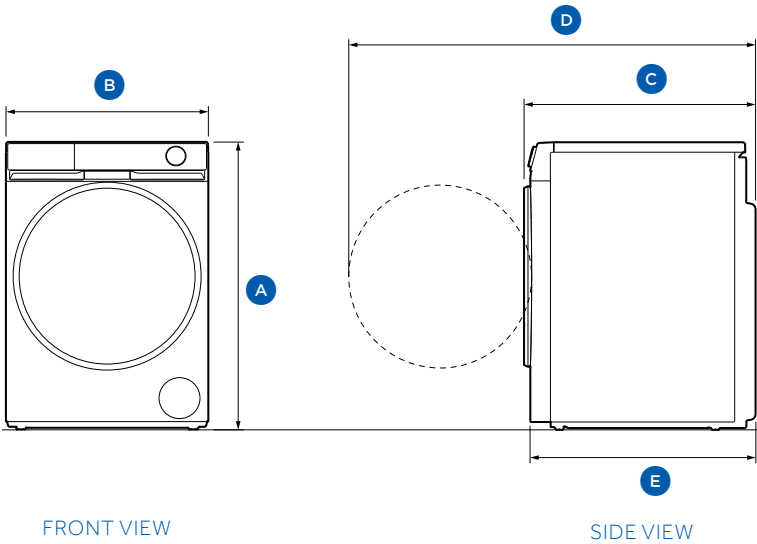

	mm
A Overall height	845 - 855
B Overall width	595
C Overall depth (door closed)	680
D Overall depth (door open)	1171
E Overall depth (excluding door)	658

CAVITY DIMENSIONS

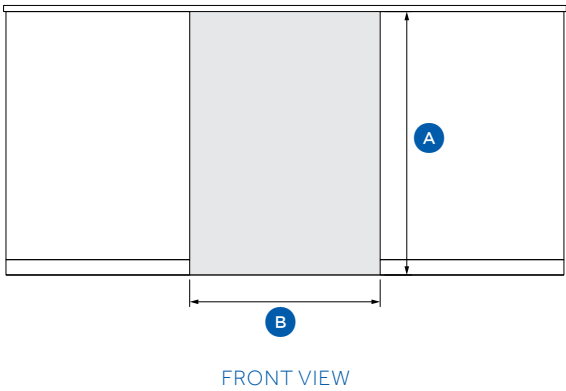

	mm
A Minimum height of cavity	865
B Minimum width of cavity	622
C Minimum clearance at back of cavity	30
D Minimum depth of cavity (excluding product door)	688
E Minimum clearance at front of cavity for in cupboard	40
F Minimum depth of cavity in cupboard	750

Note: If installing behind a cabinetry door, it must be hinged on the same side as the dryer. There must be a minimum clearance of 40mm from the front of the dryer door to the internal face of the cabinetry door for the product to operate safely.

The enclosed space must be provided with sufficient ventilation to meet local building code requirements or the door must be open while the product is operating.

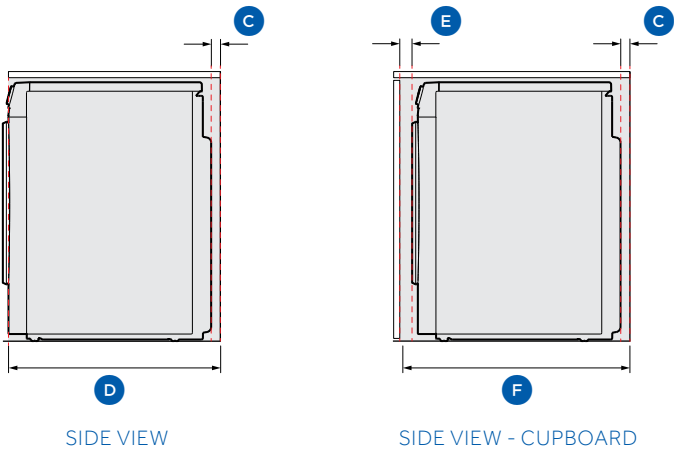

SERVICES

- Supply 220-240 V, 50 Hz
- Service 10 A
- Connection Flex cord with plug

The models shown in this Specification Guide (SG) may not be available in all markets and are subject to change at any time. Product specifications may vary from those shown. This SG should not be used as installation guidance for any product. Further information is required to safely and correctly install the products featured here. Specific installation guidance will be available with the product on delivery and on our website haier.com

Product Overview

PRODUCT DIMENSIONS

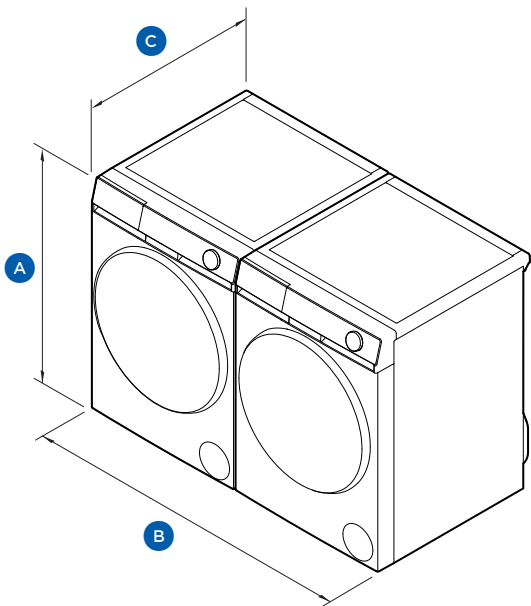

		mm
A	Minimum height	850
B	Overall width	1207
C	Overall depth (door closed)	680

CAVITY DIMENSIONS

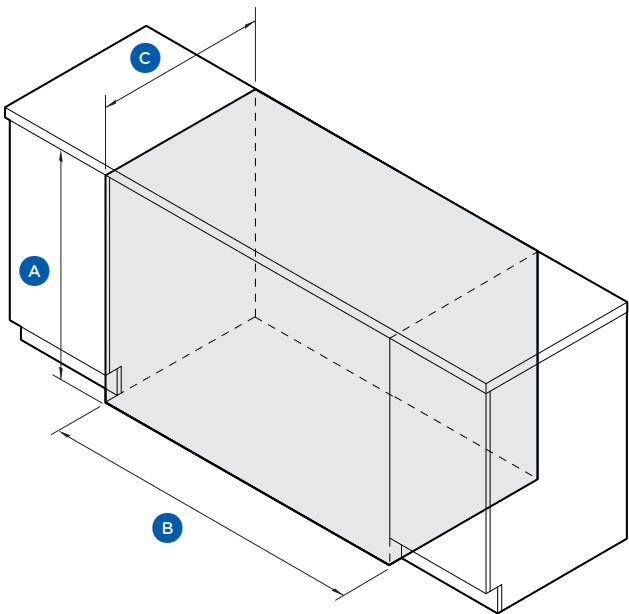

		mm
A	Minimum height of cavity	865
B	Minimum width of cavity	1234
C	Minimum depth of cavity (excluding product door)	688
	Minimum depth of cavity in cupboard	750

Note: For more details on ventilation and behind cupboard installation requirements, refer to the individual product overview pages.

Product Overview

PRODUCT DIMENSIONS

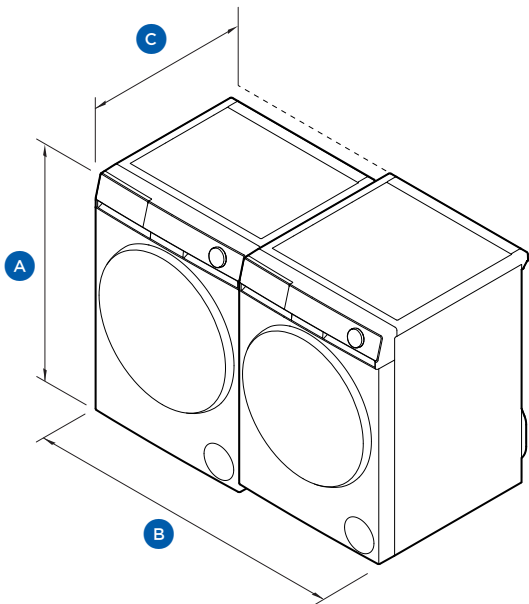

	mm
A Minimum height	850
B Overall width	1207
C Overall depth (door closed)	680

CAVITY DIMENSIONS

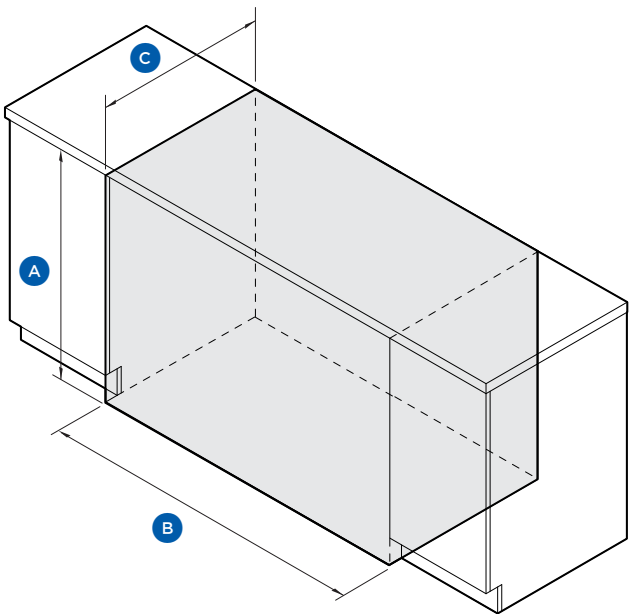

	mm
A Minimum height of cavity	865
B Minimum width of cavity	1234
C Minimum depth of cavity (excluding product door)	688
Minimum depth of cavity in cupboard	750

Note: For more details on ventilation and behind cupboard installation requirements, refer to the individual product overview pages.

Product Overview

PRODUCT DIMENSIONS

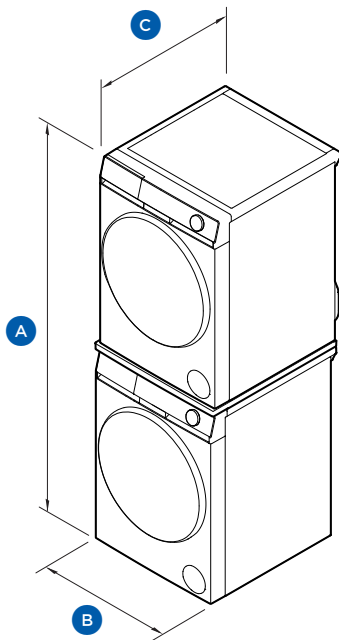

		mm
A	Minimum height*	1696
B	Overall width	595
C	Overall depth (door closed)	680

*Including stacking kit height (sold separately).

CAVITY DIMENSIONS

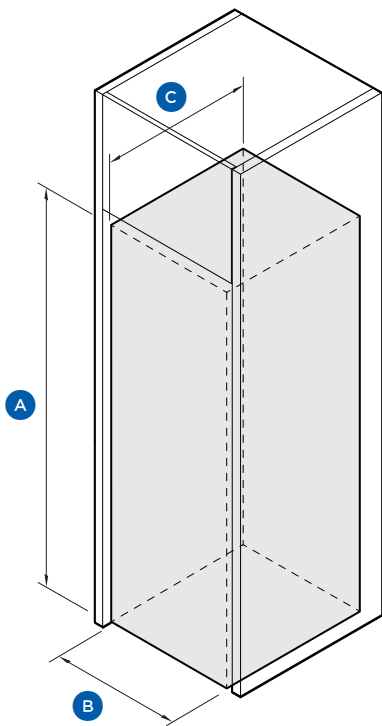

		mm
A	Minimum height of cavity	1711
B	Minimum width of cavity	622
C	Minimum depth of cavity (excluding product door)	688
	Minimum depth of cavity in cupboard	750

Note: For more details on ventilation and behind cupboard installation requirements, refer to the individual product overview pages.

Product Overview

PRODUCT DIMENSIONS

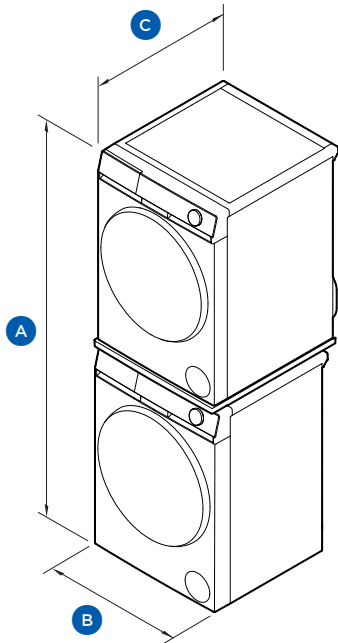

		mm
A	Minimum height*	1696
B	Overall width	595
C	Overall depth (door closed)	680

*Including stacking kit height (sold separately).

CAVITY DIMENSIONS

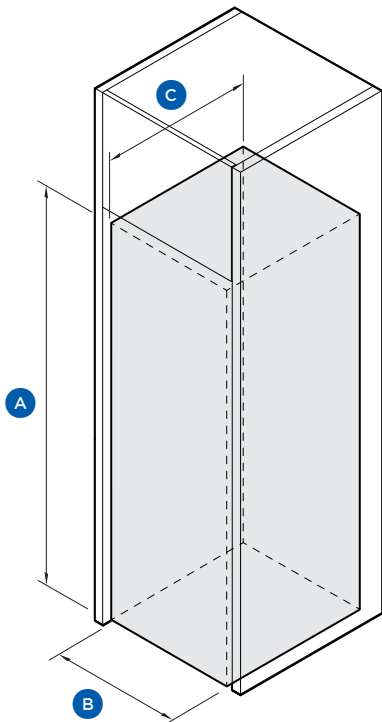

		mm
A	Minimum height of cavity	1711
B	Minimum width of cavity	622
C	Minimum depth of cavity (excluding product door)	688
	Minimum depth of cavity in cupboard	750

Note: For more details on ventilation and behind cupboard installation requirements, refer to the individual product overview pages.