

HWF10NB1, HWF10NW1

10kg 500 Series Front Loader Washing

Haier



HWF10NB1



HWF10NW1

Height
850 - 860mm

Width
595mm

Depth
593mm

Weight (Packaged)
77kg

Weight (Product)
75kg

FEATURES

- 10kg capacity fits a full basket or clothes or towels
- 5-star energy and 4.5-star water ratings
- 14 cycles, including a Woolmark Black certified cycle for machine-washable woollens
- Smart Dosing measures and dispenses detergent, while Essence Wash pre-mixes it to improve wash performance
- Ultra Quick effectively washes a 5kg load in under 30 minutes
- UV Protect to kill more than 99.99% of bacteria*
- Inverter Direct-Drive motor delivers reliable performance, backed by a 10-year warranty on the motor (2 years parts and labour, additional 8 years parts only) for extra peace of mind
- Available in White or Dark, designed to pair with our matching Haier Heat Pump Dryer
- Wi-Fi connectivity with the SmartHQ™ app

*Independently tested to eliminate greater than 99.99% of staphylococcus aureus and E. coli using the Cotton cycle + UV Sanitise wash option

ACCESSORIES

- ASKDNB1 (Stacking Kit Dark)
- ASKDNW1 (Stacking Kit White)

The models shown in this Specification Guide (SG) may not be available in all markets and are subject to change at any time. Product specifications may vary from those shown. This SG should not be used as installation guidance for any product. Further information is required to safely and correctly install the products featured here. Specific installation guidance will be available with the product on delivery and on our website haier.com

Haier

HDHP90NB1, HDHP90NW1

9kg 500 Series Heat Pump Dryer



HDHP90NB1



HDHP90NW1

Height

845 - 855mm

Width

595mm

Depth

678mm

Weight (Packaged)

63kg

Weight (Product)

58kg

FEATURES

- 9kg capacity for everything from daily laundry or larger loads
- 9-star energy rating for energy conscious households
- With 14 cycles for everything from Bedding to Shirts
- Refresh with Steam helps reduce wrinkles and smells in clothes
- Woolmark Blue certified Wool cycle for hand-wash only garments
- Sanitise to kill over 99.9% of bacteria*
- Reversible door for flexible installation
- Available in White or Dark, designed to pair with our matching Haier Front Load Washer
- Wi-Fi connectivity with the SmartHQ™ app

*Independently tested to eliminate greater than 99.9% of staphylococcus aureus and E. coli using the Allergy Care cycle

ACCESSORIES

- ASKDNB1 (Stacking Kit Dark)
- ASKDNW1 (Stacking Kit White)

The models shown in this Specification Guide (SG) may not be available in all markets and are subject to change at any time. Product specifications may vary from those shown. This SG should not be used as installation guidance for any product. Further information is required to safely and correctly install the products featured here. Specific installation guidance will be available with the product on delivery and on our website haier.com

Product Overview

PRODUCT DIMENSIONS

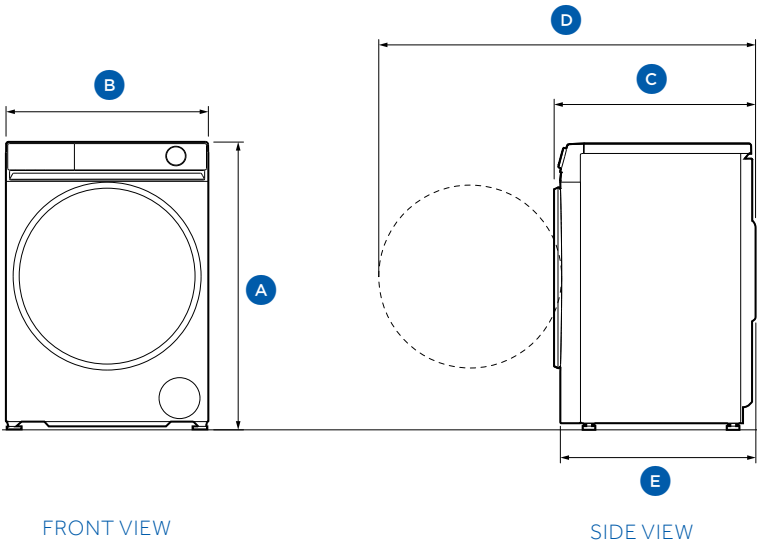

	mm
A Overall height	850 - 860
B Overall width	595
C Overall depth (door closed)	593
D Overall depth (door open)	1084
E Overall depth (excluding door)	570

CAVITY DIMENSIONS

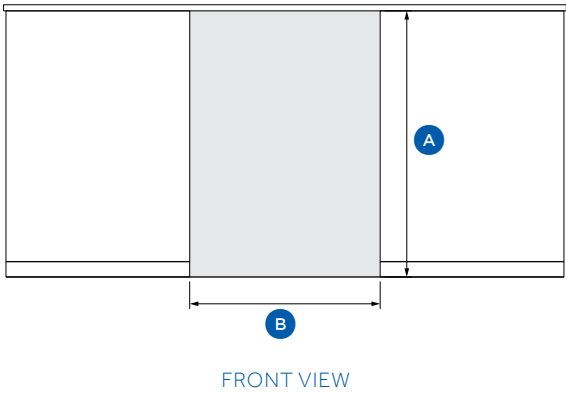

	mm
A Minimum height of cavity	865
B Minimum width of cavity	622
C Minimum clearance at back of cavity	30
D Minimum depth of cavity (excluding product door)	600
E Minimum clearance at front of cavity for in cupboard	30
F Minimum depth of cavity in cupboard	653

Note: If installing behind a cabinetry door, it must be hinged on the same side as the washing machine. There must be a minimum clearance of 30mm from the front of the washing machine door to the internal face of the cabinetry door for the product to operate safely.

The enclosed space must be provided with sufficient ventilation to meet local building code requirements or the door must be open while the product is operating.

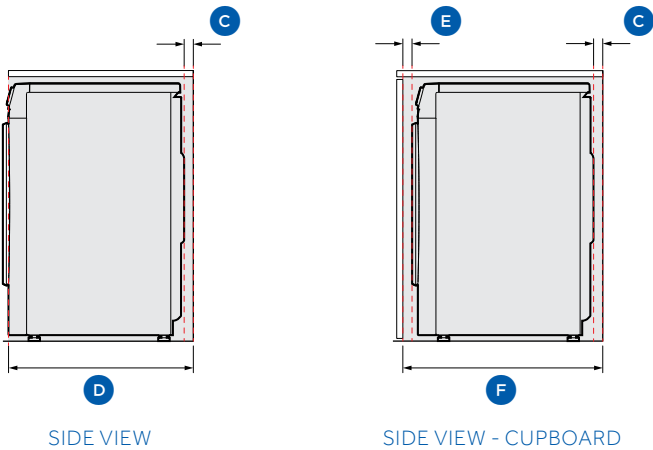

SERVICES

- Supply 220-240 V, 50 Hz
- Service 10 A
- Connection Flex cord with plug

Product Overview

PRODUCT DIMENSIONS

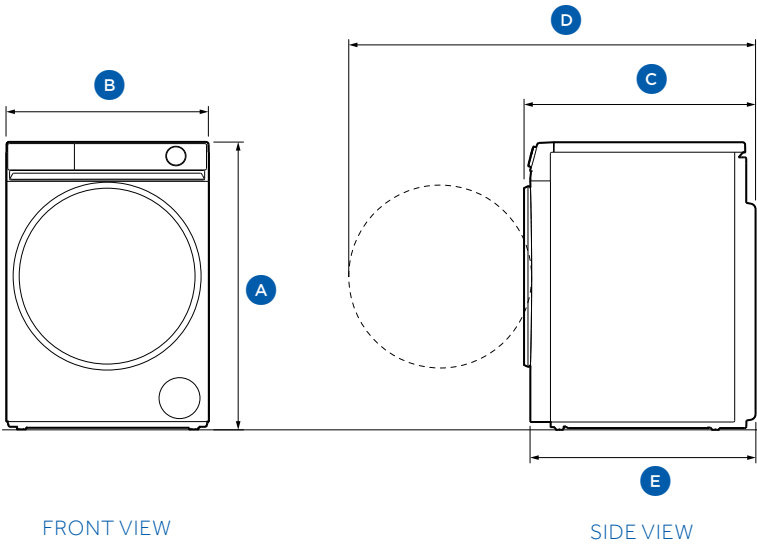

	mm
A Overall height	845 - 855
B Overall width	595
C Overall depth (door closed)	678
D Overall depth (door open)	1169
E Overall depth (excluding door)	656

CAVITY DIMENSIONS

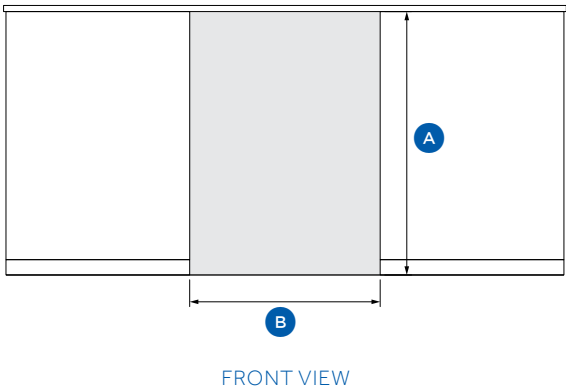

	mm
A Minimum height of cavity	865
B Minimum width of cavity	622
C Minimum clearance at back of cavity	30
D Minimum depth of cavity (excluding product door)	686
E Minimum clearance at front of cavity for in cupboard	40
F Minimum depth of cavity in cupboard	748

Note: If installing behind a cabinetry door, it must be hinged on the same side as the dryer. There must be a minimum clearance of 40mm from the front of the dryer door to the internal face of the cabinetry door for the product to operate safely.

The enclosed space must be provided with sufficient ventilation to meet local building code requirements or the door must be open while the product is operating.

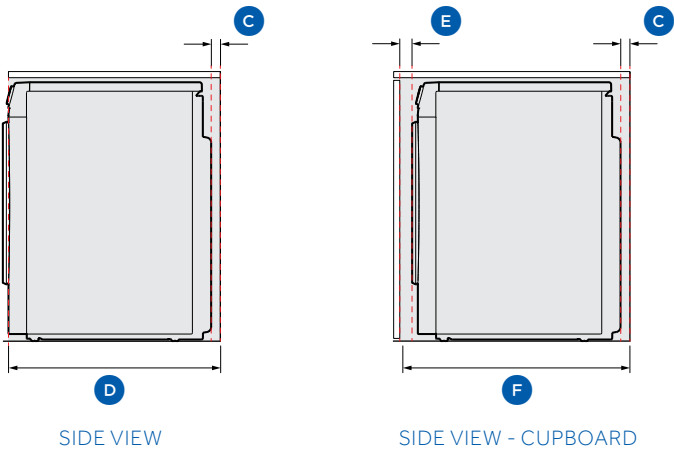

SERVICES

- Supply 220-240 V, 50 Hz
- Service 10 A
- Connection Flex cord with plug

The models shown in this Specification Guide (SG) may not be available in all markets and are subject to change at any time. Product specifications may vary from those shown. This SG should not be used as installation guidance for any product. Further information is required to safely and correctly install the products featured here. Specific installation guidance will be available with the product on delivery and on our website haier.com

Product Overview

PRODUCT DIMENSIONS

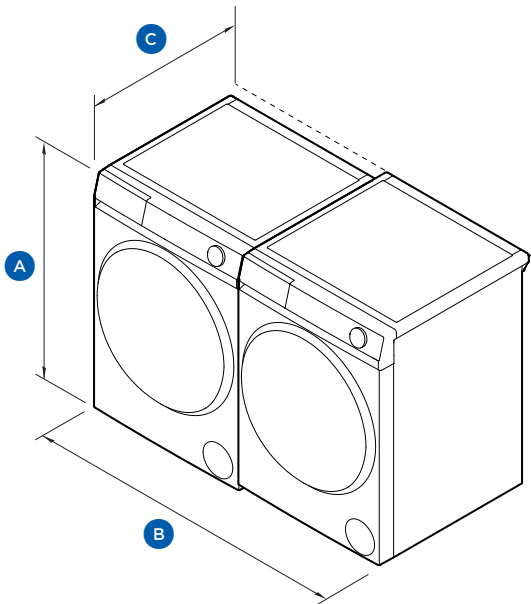

	mm
A Minimum height	850
B Overall width	1207
C Overall depth (door closed)	678

CAVITY DIMENSIONS

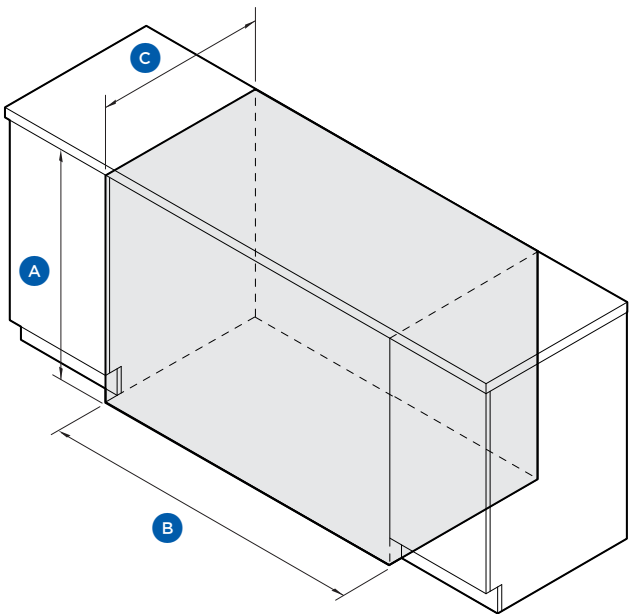

	mm
A Minimum height of cavity	865
B Minimum width of cavity	1234
C Minimum depth of cavity (excluding product door)	686
Minimum depth of cavity in cupboard	748

Note: For more details on ventilation and behind cupboard installation requirements, refer to the individual product overview pages.

Product Overview

PRODUCT DIMENSIONS

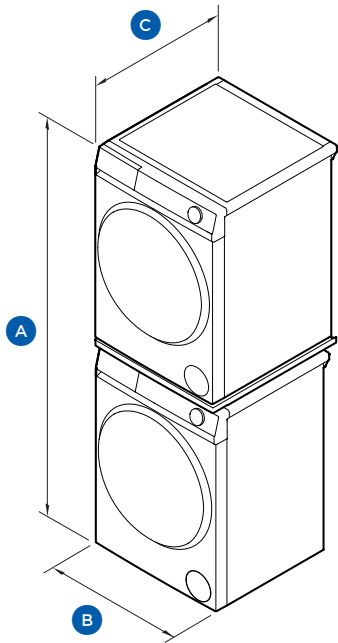

		mm
A	Minimum height*	1696
B	Overall width	595
C	Overall depth (door closed)	678

*Including stacking kit height (sold separately).

CAVITY DIMENSIONS

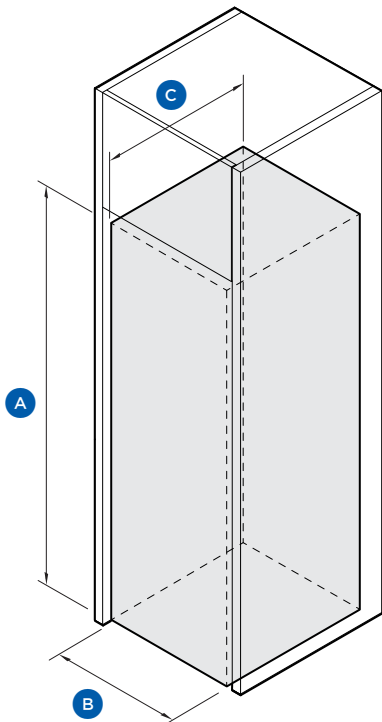

		mm
A	Minimum height of cavity	1711
B	Minimum width of cavity	622
C	Minimum depth of cavity (excluding product door)	686
	Minimum depth of cavity in cupboard	748

Note: For more details on ventilation and behind cupboard installation requirements, refer to the individual product overview pages.